

MAIN STREET DRAINAGE STRUCTURE DATA						
NO.	TYPE	STATION	RIM ELEV.	INV. IN	INV. OUT	REMARKS
48	DMH	17+82.2 26.7 RT	441.04	(88A) 438.10 (48) 437.70 (EX 48) 437.71	(52A) 438.00	
49A	DMH	17+78.1 22.2 RT	441.27	(A7A) 438.20 (EX 49A) 437.94	(48) 438.20	
49	CB	17+91.0 21.9 RT	442.60		(48) 438.54	
50	DCB CI	18+27.3 22.4 RT	439.37		(52A) 438.00	5" DIA. DOUBLE GRATE
51	EX DMH	18+42.3 26.9 RT	430.71	(52A) 434.54 (5A) 435.90	(52) 434.54	REMO'D EX DMH
52A	DMH	18+20.5 26.8 RT	440.03	(48) 434.70 (50) 435.90	(51) 434.00	
52	DCB	18+26.4 18.6 LT	436.26		(50) 435.90	5" DIA. DOUBLE GRATE
53	EX DMH	18+71.8 18.9 LT	438.42	(52) 435.30 (51) 433.91 (54) 435.30	EX	REMO'D EX DMH



-Contractor to coordinate with any abutter who is completely blocked by construction operations

-if remaining road width in field requires sidewalk to be blocked by equipment or used for widening, the contractor will implement MassDOT Figure PED-7. (attached)

-Work hours will be standard 7AM-3PM. With a possible extension to 5PM when needed

-24 Hour police details

-Cones to be used to delineate traffic

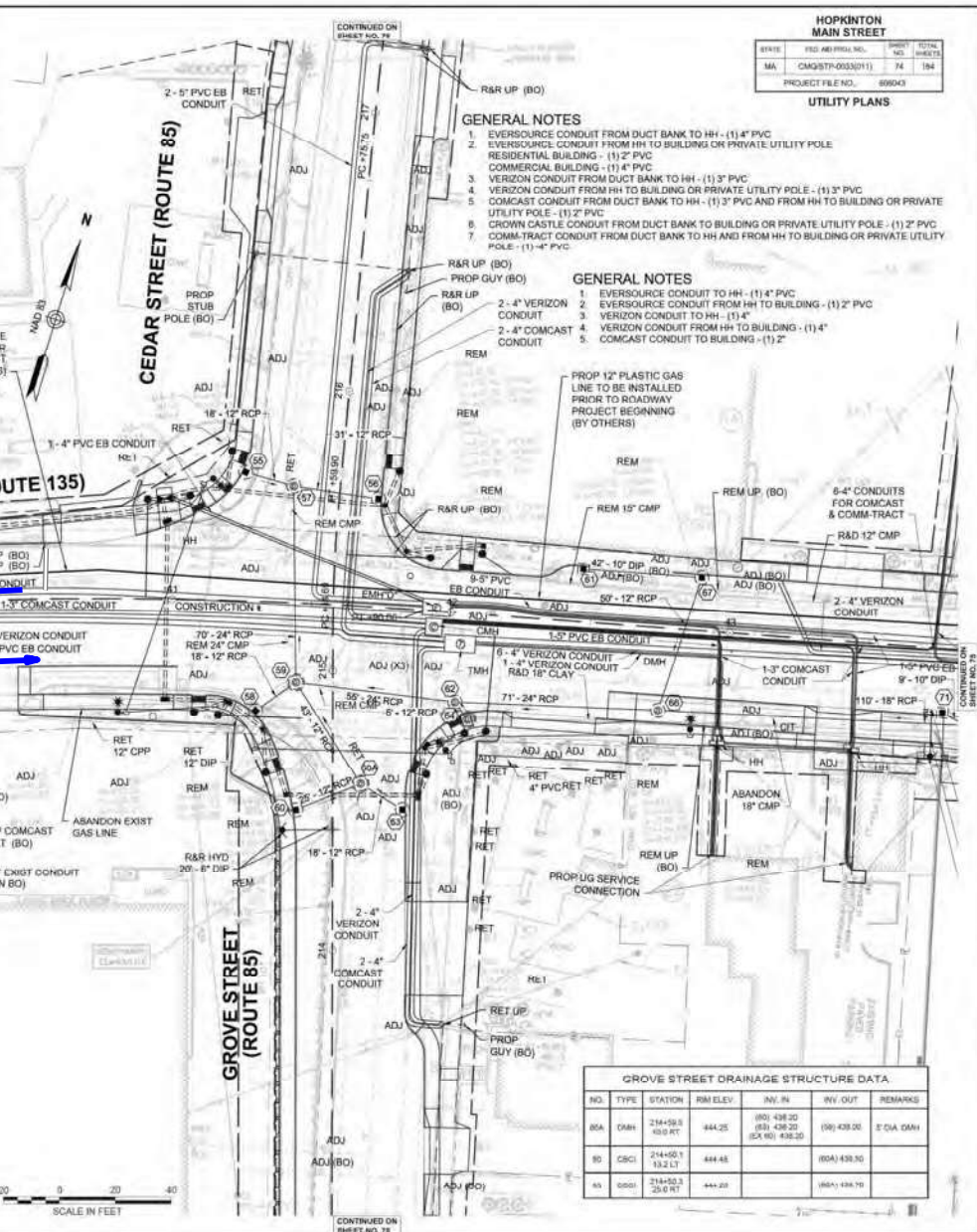

HOPKINTON MAIN STREET			
DATE	ISSUED BY	NO.	TOTAL SHEETS
MA	CAQ237R-0332(11)	74	194
PROJECT FILE NO.		89043	

- GENERAL NOTES**
- EVERSOURCE CONDUIT FROM DUCT BANK TO HH - (1) 4" PVC
 - EVERSOURCE CONDUIT FROM HH TO BUILDING OR PRIVATE UTILITY POLE - (1) 2" PVC
 - VERIZON CONDUIT FROM DUCT BANK TO HH - (1) 3" PVC
 - VERIZON CONDUIT FROM HH TO BUILDING OR PRIVATE UTILITY POLE - (1) 2" PVC
 - COMCAST CONDUIT FROM DUCT BANK TO HH - (1) 3" PVC AND FROM HH TO BUILDING OR PRIVATE UTILITY POLE - (1) 2" PVC
 - CROWN CASTLE CONDUIT FROM DUCT BANK TO BUILDING OR PRIVATE UTILITY POLE - (1) 2" PVC
 - COMM-TRACT CONDUIT FROM DUCT BANK TO HH AND FROM HH TO BUILDING OR PRIVATE UTILITY POLE - (1) 4" PVC
- GENERAL NOTES**
- EVERSOURCE CONDUIT TO HH - (1) 4" PVC
 - EVERSOURCE CONDUIT FROM HH TO BUILDING - (1) 2" PVC
 - VERIZON CONDUIT TO HH - (1) 4" PVC
 - VERIZON CONDUIT FROM HH TO BUILDING - (1) 4" PVC
 - COMCAST CONDUIT TO BUILDING - (1) 2" PVC

MAIN STREET DRAINAGE STRUCTURE DATA						
NO.	TYPE	STATION	RIM ELEV.	INV. IN	INV. OUT	REMARKS
52	DMH	42+02.7 21.8 RT	444.32	(88) 438.70 (94) 438.70	(98) 438.80	
54	DMH	42+08.6 57.7 RT	445.03	(83-04) 441.03 (EX 54A) 439.88	(82) 439.30	
55	DMH	42+76.4 26.8 RT	440.80	(87) 441.03 (70) 441.30	(82) 441.00	
56	DCB	42+38.5 18.5 LT	440.81	(81) 441.33 (86) 441.23		
71	DCB	44+77.8 23.0 RT	450.81		(70) 448.61	

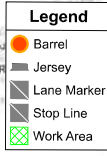

- Manifest**
- 257 ft Lane Marker
 - 91 ft Jersey
 - 11 ft Stop Line
 - 34 x Barrel
 - 2 x G66-62 Police
 - 2 x Turn Signal
 - 2 x W1-4L
 - 2 x W5-1 road narrows

Sign Spacing = 100'

SPECIAL NOTES
THE CONDUIT SHALL BE PLAYED PER THE DIRECTION OF THE RESPECTIVE UTILITY COMPANIES AT THE SIX' CROSS CULVERT.

GROVE STREET DRAINAGE STRUCTURE DATA						
NO.	TYPE	STATION	RIM ELEV.	INV. IN	INV. OUT	REMARKS
85A	DMH	214+59.5 02.0 RT	444.25	(80) 438.30 (81) 438.20 (EX 80) 438.20	(80) 438.00	5" DIA DMH
85	DCB	214+05.1 13.2 LT	444.45		(80A) 438.30	
85	DCB	214+02.3 25.0 RT	444.20		(86A) 438.70	